

Wisconsin Land Information Association 2005 Annual Conference

Final Program



“Tackling Data Integration”

February 22 - 24, 2005
KI Convention Center
Green Bay, Wisconsin



WLIA
Conference 2005

"Tackling Data Integration"

February 22 - 24, 2005

KI Convention Center & Regency Suites, Green Bay

WELCOME to the 18th Annual WLIA Conference at the KI Convention Center in Green Bay, Wisconsin. I am sure you will find this year's conference exciting from all activities including workshops, plenary sessions, technical sessions, an exhibit hall, map gallery, as well as special interest meetings.

Based on all of the past comments from our members, we have made significant changes to the conference format. With this new format, your comments are critical. Please take a few minutes to complete the conference evaluations forms. We need your feedback to continue to improve the conference for years to come.

I would like to take this opportunity to personally thank the entire conference committee, the WLIA Board of Directors and of course, Ann Barrett, our Executive Services Manager. Without their help, this event would not have been possible.

2005 promises to be another exciting year for the Association. We are once again facing challenges with the WLIP future and structure at the state level. We are also seeing resurgence in interest in the Association as the technology continues to expand into more private and public sectors. As the President of the Association, I am relying on all of our members to continue to become involved in defining our future. Whether it is serving on a committee, helping with the conference or regional meetings, writing a short article for the newsletter or making a presentation, we all have great ideas and information to share. This organization is what we all make it. Let's work together to make it the best it can be!

With that in mind, I want to extend to each and every one of you the opportunity to express your ideas and concerns with me throughout the year. Please don't hesitate to contact me via phone (920) 849-1442 or via email at Pabich.Ken@co.calumet.wi.us.

Thanks again for coming and enjoy the conference!

Ken Pabich
President
Wisconsin Land Information Association
2005 - 2006

WLIA 2005 Annual Conference Highlights

Pre-Conference Workshops

This year's conference will include nine (9) excellent pre-conference workshops.

Opening Plenary Session

This year's opening session will highlight Larry McCarren; former Packer player, Green Bay Packer Hall of Famer, and now WFRV CBS Sports Director who will open the conference showing the importance of leadership, teamwork, and having fun.

Exhibit Hall

See the latest in GIS technology and speak with the "experts" in the Exhibit Hall. The Exhibit Hall hours will be: Wednesday, February 23 from 10:00 am - 7:30 pm and Thursday, February 24 from 7:15 am to 10:15 am.

Fun Night Activity

Please join WLIA members in a fun-filled evening event beginning at 5:00 p.m. We will be heading to Packer headquarters to take in the Hall of Fame, Stadium tours of Lambeau Field and a reception in the atrium. The cost of the event is \$20 for the reception, \$9 for the Hall of Fame Tour and \$8 for the Stadium Tour. Transportation from the Regency to Lambeau Field will leave at 4:30 pm from the hotel and will run continuously.

Map Gallery Competition

The Map Gallery is the place to see and be seen; enter your own map into the contest. There are two additional categories in this year's competition: Web-based Mapping Site and brochures.

Awards

Once again, WLIA will present awards to the "best of the best". This is our equivalent to the Academy Awards. Join us in congratulating our 2005 winners.

Technical Sessions

This year's conference boasts over 50 technical sessions in ten different tracks. Take a careful look at the sessions listed – you are sure to find something for everyone.

WLIA Town Meeting

This annual event is our members' opportunity to discuss upcoming events and directions for our organization's future. Please plan on attending and voicing your interests!

Job Board

Bring your job posting to the conference and find a great professional to add to your staff. The job board will be accessible to all conference registrants near conference registration.



WLIA 2005 Annual Conference Overview

KI Convention Center/Regency Suites, Green Bay, Wisconsin

Tuesday

9:00	GIS: An Essential Tool in Every Emergency Operation Center	Mapping Field Trips and Scenic Routes with GPS & WisconsinView	Overview of ArcGIS 9	Introduction to Geoprocessing Using Models and Scripts	Building Alliances	Exhibitors
9:30						NA
10:00						
10:30						
11:00						
11:30						
12:00						
12:30						
1:00						
1:30						
2:00	Exploring GIS Tools for Land Use Modeling	On the Road to Enterprise GIS in Waukesha County	Utilizing Autodesk Map 3D 2005 for GIS	CAD and GIS Integration in ArcGIS 9	Building Alliances <i>Continued</i>	Exhibitors Setup
2:30						
3:00						
3:30						
4:00						
4:30						
5:00						
5:30						
6:00						
6:30						
7:00						
7:30						
8:00						

WLIA 2005 Annual Conference Overview

KI Convention Center/Regency Suites, Green Bay, Wisconsin

Wednesday

	Track 1	Track 2	Track 3	Track 4	Exhibitors	
7:00						
7:15						
7:30						
7:45						
8:00						
8:15						
8:30						
8:45						
9:00						
9:15						
9:30						
9:45						
10:00						
10:15						
10:30						
10:45						
11:00						
11:15						
11:30						
11:45						
12:00						
12:15						
12:30						
12:45						
1:00						
1:15						
1:30						
1:45						
2:00						
2:15						
2:30						
2:45						
3:00						
3:15						
3:30						
3:45						
4:00						
4:15						
4:30						
4:45						
5:00						
5:15						
5:30						
5:45						
6:00						
6:15						
6:30						
6:45						
7:00						
7:15						
7:30						
7:45						
8:00						
<p>WLIA Board Meeting</p> <p>Conference Opening and Keynote Speaker</p> <p>Exhibit Hall Time</p> <p>Licensing Geographic Data & Services</p> <p>Wisconsin Land Information Program Update: <i>Joanna Schumann, WDOA</i> Lunch: Town Meeting & Awards</p> <p>Exhibit Hall Time</p> <p>Poster Competition / Reception</p>						
	Iowa County's Cemetery Pilot Project	The Arsenic Special Casing Area... Groundwater Flow Models: The Connection Between Geology, Water Use, and Water Levels	The Web	The NAZCA Property Management Portal	Emergency Services	Exhibitors Setup
	WI County Coordinate Systems	H2O			GIS in Homeland Security Experiences in 911 Development	
	Government & Policy	Government & Policy	Government & Policy	Government & Policy	Government & Policy	Exhibits Open
					Emergency Data Collection - The Easton Tornado Dane County 911 Center: A Plan for GIS Implementation	
	NSDI Institution Building and Coordination: Bridging People Together	Advanced ArcGIS Concepts for Land Records Management Creating & Moving to a Shared Parcel Data Model	The Web	Bring GIS Data to the Web Municipally Web Mapping Incrementally	Emergency Services	Exhibits Open
	NRCS Soil Data Mart	Data Migration			5 Alarm GIS City of Sheboygan Emergency Response	
	Government & Policy	Government & Policy	Government & Policy	Government & Policy	Government & Policy	Exhibits Open
					Hand Held GIS Technology How Good Will My GPS Position Be?	

WLIA 2005 Annual Conference Overview

KI Convention Center/Regency Suites, Green Bay, Wisconsin

Thursday

	Track 1	Track 2	Track 3	Track 4	Exhibitors
7:15					
7:30	Breakfast with Exhibitors				
7:45					
8:00					
8:15	Plenary Session:				
8:30					
8:45					
9:00	Keeping the Cadastre: The Real Property Listers Role in Property Assessment & Land Records	WI Aerial Imagery 2005 Creative Partnering Strategies for Data Acquisition	Electric Transmission Line Siting and Routing Onsite Wastewater Treatment Facilities Management System	Integrating Parcels into Farm Records Management Attribute Centerlines from Parcels	Exhibits Open
9:15					
9:30					
9:45	Assessment Data Integration & Data Transfers				
10:00					
10:15					
10:30					
10:45	Snow Plow Routing and Optimization	Historical Digital Orthophotography 101	A Comprehensive Web Resource for Community Planning	A New Look for Zoning and Planning Technology	
11:00					
11:15	Data Integration Between County Offices	LIDAR: Not Just for Orthos Anymore	Thinking Long Term & Big Picture: Land Use Planning in Dane County	Faster, Easier Parcel Mapping in ESRI ArcGIS 9	Exhibitor Take Down
11:30					
11:45					
12:00					
12:15	Data Integration & Quality Assurance in a New Municipal Enterprise GIS	Jefferson County LIDAR Terrain Mapping Project	Yellow River Watershed-Using ArcIMS for Comp Planning	River Alliance Small Dam Removal Prioritization	
12:30	Integrating As-Built Policies and GIS Maintenance Procedures	Address Mapping in Ozaukee County: A Different Route	The MapTEACH Project: Place-Based Geospatial Science Learning & Applications in Alaska	Visual Intelligence for Land Information	
12:45					
1:00	Lunch / Awards / Prizes				
1:15					
1:30					
1:45					
2:00					
2:15					
2:30	New WLIA Board Meeting				
2:45					
3:00					NA

Pre-Conference Workshops

Tuesday, February 22, 2005

Workshops will be held on Tuesday, February 22, 2005 at the KI Convention Center in Green Bay. Workshops are not included in the conference registration fee. WLIA reserves the right to cancel and refund registration fee for any workshop.

Workshop fees: Half-day workshop = \$40 member/\$50 non-member each
Registration fee includes lunch for two half-day workshops.
You may also register separately for lunch.

Workshop 1 - Ballroom A1

Tuesday, 9:00 AM – Noon (Half Day Workshop)

GIS: An Essential Tool in Every Emergency Operation Center

Jeff DuMez, Brown County LIO; Ed Sheppard, Terrorism Exercise Coordinator; Jeff Stauber, Green Bay Fire Chief; Cullen Peltier, Brown County Emergency Manager

The intent of this workshop is two-fold: First, anyone who participates in Emergency Operations Centers (EOC) should get to know how our Land Information Systems can be used for a variety of applications including, but not limited to, mapping during an emergency. Second, LIOs and other GIS operators need to know what to anticipate and how the needs of EOC personnel can be translated into functional requirements.

Workshop 2 - Ballroom A1

Tuesday, 1:30 PM - 4:30 PM (Half Day Workshop)

Exploring GIS Tools for Land Use Modeling

Tom McClintock, Math Heinzl and Jennifer Borlick, UW-Madison - LICGF

This half day workshop will consist of lectures and demonstrations of using several different methods of modeling land use suitability and allocating future growth for Dane County, Wisconsin. We will use ArcGIS 9 Model Builder, WhatIf and CommunityViz software.

Workshop 3 - Ballroom A2

Tuesday, 9:00 AM – Noon (Half Day Workshop)

Mapping Field Trips and Scenic Routes with GPS & WisconsinView

Tim Olsen, Sam Batzli, Bill Aldrich, Scott Gebhardt and Khary Jeffers, Environmental Remote Sensing Center

Learn to use GPS tracking functionality and photos taken along a route to educate people; including K-12 students, citizens, tourists and (yes) Packer Fans, to find their way to places of interest the digital way. Generate maps with WisconsinView.org on-line satellite images, GIS data and city-county air photos to provide a context for GPS track and hot-linked photos. See how to upload map layers with tracks into handheld GPS units to provide a guide for field trips, walking tours, nature hikes, or scenic drives. Educators can help students document their own environmental field trips, and see the path taken on web-served topo map layers; via internet browsers on PCs or Macs. For learning by doing bring a coat, digital camera, GPS unit and laptop (as available – we’ll have a few extras just in case). We’ll be exploring the neighborhood nearby and working hands-on.

Join Us for a Night of Fun!!! Please join WLIA members in a fun-filled evening event beginning at 5:00 p.m. We will be heading to Packer headquarters to take in the Hall of Fame, Lambeau Field Stadium tours and a reception in the Atrium. This is a separate cost from the conference. Transportation will be provided. Cost is \$20 for the reception, \$9 for the Hall of Fame Tour and \$8 for the Stadium Tour.

Workshop 4 - Ballroom A2

Tuesday, 1:30 pm - 4:00 pm (Half Day Workshop)

On the Road to Enterprise GIS in Waukesha County

Don Dittmar, Jim Landwehr and William Cozzens, Waukesha County

Waukesha County is moving along the road to creating an Enterprise GIS. As with all journeys, this one has encountered some potholes, misstarts, and detours, as well as some good pavement. Along the way, issues related to Geodatabase design, legacy data conversion, workflow management, maintenance, redeployment of existing applications, the creation of new applications, and developing links to the County's document imaging and tax system all needed to be addressed. Throw in the occasional detour to accommodate the needs of our local municipalities, the creation and integration of a new combined dispatch system, and the discovery that an entire new tool set was needed, and you begin to get a picture of what the trip was like. The lessons learned regarding how the full integration of all data and applications can at once be a blessing and a curse should prove enlightening to anyone who cares to join us as we recreate the journey.

Workshop 5 - Ballroom A3

Tuesday, 9:00 AM – Noon (Half Day Workshop)

Overview of ArcGIS 9

Kendis Scharenbroich and Jennifer Ward, Pro-West & Associates

This workshop will demonstrate the newest functionality in ArcGIS 9.0. Topics will include expanded geoprocessing tools, work performance, mobile mapping toolbars and shortcut keys. We will also cover the tips and tools that will make you a proficient ArcView 9.0 user, such as, toolbar customizations, cartography tips, table editing and georeferencing images. A manual with step-by-step instruction will be provided. ArcGIS experience is required.

Workshop 6 - Ballroom A3

Tuesday, 1:30 PM - 4:30 PM (Half Day Workshop)

Utilizing Autodesk Map 3D 2005 for GIS

Scott Hameister, Taylor Technologies, Inc.

This workshop will explore many features of Autodesk Map 3D 2005 as they pertain to setting up a functional GIS. Topics covered will include creating data rich DWF files, setting up projects and project thematic maps, intermediate to advanced labeling methods, using mathematical expressions in queries and reports, converting report queries into Excel pivot tables (i.e. GASB34 reports), and many more of the new features from the last two releases of Autodesk Map.

Workshop 7 - Ballroom A4

Tuesday, 9:00 AM – Noon (Half Day Workshop)

Introduction to Geoprocessing Using Models and Scripts

Jason Grootens, ESRI

Geoprocessing is the processing of geographic information, one of the basic functions of a GIS. ArcGIS 9 presents a comprehensive set of geoprocessing tools that work with all the supported data formats, including geodatabase features. It also offers a completely new framework for working with these tools that enables you to launch them individually, combine them together in a visual modeling environment (Model Builder), write scripts in standard scripting languages, and run the tools as commands in a command line window. This workshop will introduce ArcGIS users to building workflow models, creating and using scripts and deploying these models and scripts as tools.

Workshop 8 - Ballroom A4

Tuesday, 1:30 PM - 4:30 PM (Half Day Workshop)

CAD and GIS Integration in ArcGIS 9

Mark Midas, ESRI

Many organizations have business needs which require both CAD and GIS. There are a variety of approaches to solve this dual need. The goal of this workshop is to demonstrate how the data can be shared between both technologies. The workshop will include a discussion and demonstration of direct read and geoprocessing translation capabilities of ArcGIS 9.

Workshop 9 - Meeting Room B1

Tuesday, 9:00 AM - 4:30 PM (Full Day Workshop)

Building Alliances

WLIA 2005 Annual Conference

Wednesday, February 23, 2005

7:00 – 8:00 AM: WLIA Board Meeting

8:00 – 9:00 AM: Opening General Session & Special Guest Speaker

Welcome and Opening Remarks, *WLIA President, Alissa Bails*

****Opening Plenary Session:** *Larry McCarren*; Ex-packer player, Green Bay Packer Hall of Famer, and now WFRV CBS Sports Director will open the conference showing the importance of leadership, teamwork, and having fun.

9:00 – 10:15 AM: Technical Sessions:

Track 1: Government and Policy - Ballroom A1	9:15 AM - 10:15 AM
---	---------------------------

- **Iowa County’s Cemetery Pilot Project**

Cristina Pearson & Joe Weier, Iowa County (30 Minutes)

We will demonstrate an Iowa County Cemetery pilot project. In this session we will describe the reasons we felt this was an important project to begin and who our target audience was. We will demonstrate the data gathering, where we obtained it and how we developed our data base. We will also demonstrate the mapping processes and the final pilot project.

- **Wisconsin County Coordinate Systems: A WLIA Task Force Report**

Ted Koch, State Cartographer’s Office; Jerry Mahun, Madison Area Technical College; Diann Danielsen, Dane County; Pat Ford, Brown County and Jay Yearwood, City of Appleton (30 Minutes)

This presentation will detail the work of the WLIA’s County Coordinate Systems Task Force, formed in early 2004. The task force has a mission to explore concerns raised by a number of GIS users over apparent errors and inconsistencies in data conversions to and from the WCCS. This session will present the work of the task force - explain issues investigated, analysis performed, and the rationale for recommendations, including an explanation of the proposed redefinition of the WCCS in order to make their implementation in software and use by the mapping community understandable and efficient.

Track 2: H20 - Ballroom A2	9:15 AM - 10:15 AM
-----------------------------------	---------------------------

- **The Arsenic Special Casing Area In The Fox Valley: An Example Of Data Integration And Interagency Cooperation From Initial Research To Rule Development**

Bruce Brown and Mike Czechanski, Wisconsin Geological and Natural History Survey (30 Minutes)

High concentrations of arsenic and other heavy metals in private water wells present a potentially serious public health problem for much of the Fox Valley region. Because the minerals containing the arsenic occur throughout the region, the Department of Natural Resources (DNR) determined that scientifically based guidelines were needed to assist well drillers in constructing wells that had the highest probability of avoiding the contaminated waters. Wisconsin Geological and Natural History Survey (WGNHS) and DNR worked together to assemble and integrate existing well construction data, match wells with addresses provided by Winnebago County, interpret the geology and geometry of the aquifer system, and prepare a series of digital primary and derivative maps. The final set of township-scale maps specify a minimum casing depth required by DNR for completing a well within a specific quarter section. The cooperation and sharing of digital topography, address grids, and digital orthophotography by the involved counties was essential to the success of this project. The result will be a valuable tool for water resource management and for addressing water supply and quality issues in the comprehensive planning process.

- **Groundwater Flow Models: The Connection Between Geology, Water Use, and Water Levels**

David Hart, Wisconsin Geological and Natural History Survey (30 Minutes)

More than 70 percent of Wisconsin’s population depends on groundwater for their drinking-water needs. Groundwater flow models are essential tools for managing this resource. A study in southeastern Wisconsin provides an example of the

continued on page 9...

- *Groundwater Flow Models: The Connection Between Geology, Water Use, and Water Levels continued...*

incorporation of land information data in a regional groundwater model. Groundwater pumping in southeastern Wisconsin has produced a large cone of depression, reduced flow from groundwater to surface water (including Lake Michigan), shifted groundwater divides, increased leakage from shallow to deep parts of the groundwater flow system, and changed directions of groundwater flow. The regional groundwater flow model helps planners understand the impacts of land-use changes and allows simulation of future land-use and water-supply scenarios.

Track 3: The Web - Ballroom A3

9:15 AM - 10:15 AM

- **The NAZCA Property Management Portal**

Ted Mondale, Jason Hepp, Dominic Coates, NAZCA Solutions, Inc. and Mike Blaska, WI Counties Assn (60 Minutes)

The presentation will focus on how counties can provide a subscription service to their end users (appraisers, title companies, etc.) for them to extract property information from the county via a secure, web-enabled portal. Existing NAZCA customers experience significant gains in internal staff efficiency while maintaining or growing the revenue received from the sale of property information. The NAZCA portal dynamically integrates databases housing all types of property data: recorded documents, tax, assessment, appraisal, GIS, images, permits, etc. External end users no longer need to go to the county to retrieve the information they need to do their job - they simply subscribe to the county portal, the revenue of which goes to the county. Users are no longer in line, they're online.

Track 4: Emergency Services - Ballroom A4

9:15 AM - 10:15 AM

- **GIS in Homeland Security**

Jason Grootens and Mike Koutnik, ESRI (30 Minutes)

There have been numerous articles that described the role GIS played in the response and recovery efforts following 9/11. Since then, significant time, attention and funding have been devoted to how information technology generally, and how GIS specifically, can further objectives related to homeland security. In the first half of this session you will see a structured, process-oriented approach to applying GIS to homeland security. You will also see how GIS can facilitate integration among the various disciplines required to support homeland security objectives, including public safety, emergency management, and public health.

- **Experiences in 911 Data Development**

Nick Stadnyk, Applied Data Consultants, Inc. (30 Minutes)

ADC was selected by Eau Claire County to develop and help implement the County's 911 data. Throughout the process, a variety of unique and efficient tools were used to collect, maintain, and quality check the data. This presentation will discuss the important lessons learned and examine how the tools and techniques helped streamline the data collection process.

10:15 AM – 11:15 AM: Exhibit Hall Time with Break - Exhibit Hall C

11:15 AM – 12:30 PM Technical Sessions

Track 1: Government and Policy - Ballroom A1

11:15 AM – 12:30 PM

- **Licensing Geographic Data and Services**

William S. Holland, GeoAnalytics, Inc. and Lea Shanley, UW-Madison LICGF (60 Minutes)

This session will provide an overview of licensing of GIS/LIS data and services. There will be two parts to the session. The first will review the National Research Council's recent book, Licensing Geographic Data and Services. This review decomposes the legal, economic, and policy implications of government as licensee and licensor. The report also provides

continued on page 10...

- *Licensing Geographic Data and Services continued...*

recommendations to determine when licensing is appropriate or not and, if so, how to enhance licensing in the public sector. The second part of the session will review case studies, both positive and negative, of governments as licensee and licensor. A portion of the session will be devoted to audience questions and interaction.

Track 2: Data Migration - Ballroom A2

11:15 AM – 12:30 PM

- **Establishing the Milwaukee County Enterprise Land Information System**

Kevin White, Milwaukee County and Scott Stocking, GeoAnalytics (30 Minutes)

Discussion on the current work effort by Milwaukee County, Wisconsin, to obtain a true enterprise GIS system that services all County government agencies and municipalities. This effort includes the development of a detailed set of specifications and strategies to migrate existing County cadastral, street centerlines and street address GIS data layers into the new ESRI ArcGIS technology environment. Work included a GIS needs assessment, leading to final migration steps required for the creation of a countywide Geodatabase design for both parcel and street centerline addressing systems. Also discussed are how changes in existing governance and management structure are needed in order for the County to assume the traditional role of the LIO.

- **Green Bay Water Utility Migrates to ArcSDE Geodatabase**

Rick Hammond and John Hannel, Woolpert, Inc. (30 Minutes)

The Green Bay Water Utility, Green Bay, Wisconsin, recently migrated their existing water utility data from an ArcInfo 7x/BaySys platform to an ArcSDE geodatabase. This presentation will describe the need and resulting benefits of converting to an ArcSDE geodatabase, as well as the major aspects of the migration process which included: system setup and configuration, using both the client and contractor servers for production in two locations, geodatabase design, data projection and rubber-sheeting to a newly acquired land fabric, the use of custom tools to create and load feature linked annotation, converting four years worth of mapping updates, updating attributes from valve and hydrant cards, hyper-linking scanned documents, complete QA/QC of the data, hosting of an ArcIMS and project web site, application development, ArcFM implementation, and client training. Water/Wastewater utilities interested in the new geodatabase model will learn important concepts for data migration and conversion in an ArcGIS environment.

Track 3: The Web - Ballroom A3

11:15 AM – 12:30 PM

- **Web Mapping Services Applied and Explained**

AJ Wortley and Jim Lacy, State Cartographers Office (30 Minutes)

Come see how interoperable webmapping services can be authored through your existing ArcIMS application or webserver and when and how you might want to use this technology for current-day solutions to internal and multi-agency issues.

- **Using Condos in your ArcIMS application**

Eric Fowler, R.A. Smith & Associates, Inc (30 Minutes)

Learn the process of setting up your parcel database to access Condos via ArcIMS. Accessing your condo assessment data doesn't need to be complicated. This presentation will demonstrate the steps necessary to setup your parcel database and the different models for accessing condominiums in the assessor's database. Finally, a practical step-by-step demonstration of how to access the database model from ArcIMS. Several different examples will be given to show various presentation and "Save-As" techniques.

Track 4: Emergency Services - Ballroom A4

11:15 AM – 12:30 PM

- **Emergency Data Collection - The Easton Tornado**

Jodi Helgeson, Adams County, Lenora Borhardt, Adams County Emergency Services and Todd Halvorson, MSA Professional Services(30 Minutes)

This session will feature how a small county without an in-house GIS department functioned in the face of a tornado disaster in June 2004. It will focus on the assembly of GIS maps using semi-complete GIS data sets, discuss findings regarding accuracy issues and the dissemination of information to volunteers and emergency personnel, as well as the effort to incorporate the field information back in.

• **Dane County 911 Center: A Plan for GIS Implementation**

Rich McVicar, Anita Temple and Diann Danielsen, Dane County (30 Minutes)

In early 2004, the Dane County 9-1-1 Center developed a plan for the use of GIS and related technologies for dispatch and emergency response. The Center is the primary dispatching agency for emergencies in the County. The project was designed to supplement a broader strategic planning effort which was focused on the organizational, process, and technological components of existing response software and tabular databases. The GIS plan focuses on the spatial component of data, technology, and applications within the Center and Dane County. Another goal of this project was to assist with the procurement of equipment for a pilot AVL project tracking Advanced Life Support emergency vehicles. This WLIA presentation will outline the findings and recommendations of the 9-1-1 GIS plan, as well as provide an update on the Center's current implementations.

12:30 – 2:00 PM: Lunch / Town Board Meeting and WLIP Program Update - Meeting Room B

Wisconsin Land Information Program Update

Joanna Schumann, WI Department of Administration

Hear an update on the Wisconsin Land Information Program, including the anticipated amount of WLIP grants for FY 2005, WLIP grant status, Parcel Assessment and Tax Data Project update, and status of a recently received federal grant to coordinate Wisconsin GIS efforts.

2:00 PM – 3:15 PM Technical Sessions

Track 1: Government and Policy - Ballroom A1

2:00 PM – 3:15 PM

• **GIS at Wisconsin Emergency Management**

Chris Diller, WI Dept of Military Affairs (30 Minutes)

Wisconsin Emergency Management (WEM) is currently conducting a Homeland Security and Emergency Management GIS Needs Analysis. The role of GIS during and after the September 11, 2001 disasters highlighted the importance of GIS and gave decision makers the tools and information necessary to make better and faster decisions. WEM is conducting an analysis to determine the agency's GIS business objectives and position Wisconsin to plan and react to any disaster. Come and learn more about how WEM is accomplishing this and learn some of the preliminary findings.

• **NRCS Soil Data Mart**

Kent Pena & Carl Wacker, NRCS (30 Minutes)

Soil Data Mart, a demonstration of the new online data delivery mechanism for downloading and querying soils data.

Track 2: Data Migration - Ballroom A2

2:00 PM – 3:15 PM

• **Advanced ArcGIS Concepts for Land Records Management**

Ron Bruder, Applied Data Consultants (30 Minutes)

A successful implementation of ArcGIS for land records management requires a thorough understanding of both the advanced tools within the software itself and of the parameters established during the design stage of the Geodatabase, ArcGIS's native database format. This presentation will examine automated geoprocessing, through model building and scripting, as well as ArcObjects-based editing tools specifically as they relate to land records management. Design considerations of the Geodatabase, including Feature Dataset precision, coordinate lifecycle, and naming standards will also be addressed.

• **Creating and Moving To a Shared Parcel Data Model**

Eric Damkot, Washington County and Mat Dvorachek, City of West Bend (30 Minutes)

Washington County and the City of West Bend, the largest municipality in Washington County, historically completed parcel mapping in two different formats using two different systems. In 2004, the City and County joined forces to

continued on page 12...

- *Creating and Moving To a Shared Parcel Data Model continued...*

create a unified parcel data model and migrated all parcel data to an ESRI GeoDatabase. The new, shared model simplified both data exchange and analysis. This presentation will include the cooperative arrangement between the City and County, the steps required to create the model, how we migrated our existing data, and how the new solution was rolled out to users of the data.

Track 3: The Web - Ballroom A3

2:00 PM – 3:15 PM

- **Bring GIS Data to the Web**

Scott Hameister, Taylor Technologies, Inc. (30 Minutes)

Scott will briefly discuss several options for bringing GIS data to the World Wide Web. Options covered will include custom programming and development software. He will spend a significant amount of time discussing TTI's Rapid Integration Toolkit for ESRI ArcIMS[®] and Autodesk MapGuide[®].

- **Municipal Web Mapping Incrementally**

Tim Penfield, MSA Professional Services (30 Minutes)

This presentation will focus on how a municipality has utilized ArcIMS technology to incrementally improve its mapping systems and decisions based upon them. The municipality had recently utilized a custom mapping application for property ownership inquiries. However, with the GASB34 requirements and growing mapping needs, the municipality determined that an implemented ArcIMS MapViewer would provide them with the ability to successfully analyze and manage utility features. This decision has brought the City one step closer to a complete GIS in an affordable manner. A short demonstration at the end of this presentation will demonstrate the viewer, including the integration of property records to these mapped services.

Track 4: Emergency Services - Ballroom A4

2:00 PM – 3:15 PM

- **5 ALARM GIS**

Andy Swartz, City of Sun Prairie (30 Minutes)

The Sun Prairie Volunteer Fire Department and the City of Sun Prairie have implemented a mobile GIS tool for accessing site preplans in fire and rescue vehicles. The vendor is Group 1 and the product name is Remote Access. Remote Access is run on touch-screen mobile data terminals. This easy-to-use application gives fire fighters, emergency medical service staff, police officers, and public safety dispatchers access to several GIS base layers, custom GIS layers, site preplans, building plans, and digital images of commercial, institutional, industrial, and large residential locations. This presentation will provide a demonstration of the system, offer insights into the value of the tool, share stories on its value and limitations, and explore the quantity of effort involved in implementation and ongoing maintenance.

- **City of Sheboygan Emergency Response**

Bob Lenz, Autodesk, Inc. and Tom Horness, City of Sheboygan (30 Minutes)

This presentation revolves around the integration of critical asset data with a GIS data base to form an overall data set that allows Police, Fire, Urban Search and Rescue (USAR), and other First Responders to access critical data via mobile laptops for disaster mitigation. The presentation would utilize "real world" data from Emergency Response systems that have been recently deployed in the Midwest; specifically Sheboygan, WI, and Grand Forks, ND. Tom Horness from Sheboygan will review the city's deployment first responder software in the fire and police departments.

3:15 PM – 4:15 PM Exhibit Hall Time with Break - Exhibit Hall C

4:15 PM – 5:30 PM Technical Sessions

Track 1: Government and Policy - Ballroom A1

4:15 PM – 5:30 PM

continued on page 13...

• **The Iowa County Land Record Information System - Accomplishments and Lessons Learned**

Phil Dunshee, Iowa County Recorders Association (60 Minutes)

The Iowa County Recorders Association is implementing an initiative to create a statewide land record database that can be accessed through a net web portal. The system will be operational in January 2005, and will provide access to land record information in all 99 counties and enable electronic recording. The presentation will provide an overview of the project, describe the project plan and strategy, summarize accomplishments and lessons learned, and discuss how similar projects might be approached in other areas. Further information about the project is available at www.clris.com.

Track 2: Business GIS - Ballroom A2

4:15 PM – 5:30 PM

• **Integrating Retail Data with a GIS for Optimal Strategic Expansion**

Paul Sill, Forum Analytics, LLC (60 Minutes)

The SIMMS Software application was recognized by GeoTech Magazine in 2001 as one of the best Retail based GIS applications. SIMMS, an acronym for the Strategic Integrated Mapping and Modeling System, is being used by such firms as Ace Hardware, Sears, Saks Inc, Cousins Subs (a Wisconsin native), and several other firms to integrate over 1.5GB of retail consumer, competitive, demographic, and statistical data into a simple, point-and-click GIS application for market optimization, market potential analysis, and store performance. Though the WLIA does not typically focus on consumer-based applications, SIMMS is an excellent example of how data integration, combined with advanced statistical modeling, can lead to the development of fully automated GIS-based solutions that have a real impact on decision making at all levels of an organization.

Track 3: The Web - Ballroom A3

4:15 PM – 5:30 PM

• **Bridging the Gap Between Internet GIS Data Availability and Public Use**

Adam Dorn, Fond du Lac County (30 Minutes)

Fond du Lac County unveiled its first GIS website in June 2001. Since that time the website has had many incarnations and updates. The variety and quantity of data available is rather substantial for the average user. There are many people who use the GIS website on a daily basis. The tasks people perform can range from determining an adjacent owner to looking at a property's zoning. However, there are many people who are unaware of the GIS website or the amount of data and type of information it contains. This presentation will detail Fond du Lac County's efforts to increase the utilization and functionality of its GIS website.

• **GIS on the Web: An Integration of Maps, Property Records & Document Imaging**

Marilyn Mueller, Kewaune County and Thomas Tym, Ruekert/Mielke, Inc. (30 Minutes)

The program will be an overview of the process used by Kewaunee County to establish the land records website that allows for seamless access to its property tax records, GIS mapping, and register of deeds indexing and document imaging system. It will include a live, online demonstration of the application.

Track 4: GPS - Ballroom A4

4:15 PM – 5:30 PM

• **Utilizing Hand Held GIS Technology**

Jon Schwichtenberg, SEH (30 Minutes)

This presentation will explore the possibilities of the use of GIS in hand held applications. The presentation will cover specific GIS applications built with ArcPad for the use in hand held computers. The second part of the presentation will cover the use of GIS in conjunction with GPS units, specifically the Trimble GeoXT unit and how it can function/interact with GIS data, while performing locates and collecting GPS points.

continued on page 14...

• **How Good Will My GPS Position Be?**

Holly Urbain & Terry Lueschow, Seiler Instruments (30 Minutes)

A discussion on the variety of Global Positioning System (GPS) equipment available for you to use depending upon the accuracy you require. How accurate does your map data need to be? Do you need accurate vertical positions? The topics of recreational GPS up to Real Time Kinematic (RTK) GPS will be discussed along with the various correction sources available to improve your GPS results.

Wednesday, February 23, 2005

5:30 PM – 7:30 PM:

Reception with Exhibitors and Poster Competition - Hall C

WLIA 2005 Annual Conference

Thursday, February 23, 2005

7:15 AM – 8:00 AM: Breakfast with Exhibitors: Did you miss your chance to talk with an Exhibitor during the reception? Come enjoy breakfast with the Exhibitors before the conference begins.

8:00 – 8:45 AM: Plenary Session: Matt Miszewski, CIO, WDOA: “Vision of Land Records in WI” - Rm B

8:45 AM – 10:00 AM: Technical Sessions

Track 1: Property - Ballroom A1

8:45 AM – 10:00 AM

• **Keeping the Cadastre: The Real Property Listers Role in Property Assessment and Land Records**

Roxanne Moore, Burnett County; David Addison and Brian Braithwaite, Washington County (30 Minutes)

One of the most important parts of Land Records is the concept of ownership interests. These interests are the major component of a multi-purpose cadastre. Coupled with parcel mapping, the cadastre forms the bedrock upon which proper valuation of property for assessment and taxation purposes are built. Maintaining this information in the State of Wisconsin is the Real Property Lister. Charged with the collection, organization and distribution of land records related to ownership, the Real Property Lister performs a critical role in assessment and land records. This presentation will briefly touch the origins of the modern cadastre; the history of the Real Property Lister and its place in land information; the Real Property Listers role in assessment process; plus an overview of skills and techniques used by the Real Property Lister in the fulfillment of their duties.

• **Assessment Data Integration & Data**

Mike & Bob Grotz, Grotz Appraisals (30 Minutes)

Exchanging data between the County LIO and the Assessor. A discussion on how to save time and work in your office, as well as share important information that will expand the capabilities of your GIS.

Track 2: Imagery & Terrain - Ballroom A2

8:45 AM – 10:00 AM

• **Wisconsin Aerial Imagery - 2005**

Ted Koch, State Cartographers Office (30 Minutes)

Aerial imagery has become a mandatory base information component of most geospatial applications. In 2005 an amazing wealth of imagery will be collected over the state, most of which will be processed into digital orthophotos.

continued on page 15...

- *Wisconsin Aerial Imagery - 2005 continued...*

Acquisition of this imagery is being coordinated by a variety of organizations, including county consortiums, federal agencies, and commercial satellite firms. Additionally, some are using special processing approaches to convert older imagery into digital products. This session will report on the current status and plans for imagery around the state, and then analyze some of the policies and coordination approaches (or lack thereof) that are guiding the collection of this valuable information resource.

- **Creative Partnering Strategies for Spatial Data Acquisition**

Kirk Contrucci, Ayres Associates and Panel (30 Minutes)

Several Consortiums were developed by counties whose goal is to lower the costs of spatial data acquisition while cooperatively sharing the resulting map data. The counties vary in terrain characteristics, population trends, land cover, geographic location, and land information resources. Each county's strategy for securing additional partners, by necessity, varies as well. This presentation will focus on the unique challenges and impressive benefits that result from successful data acquisition partnerships.

Track 3: Utilities - Ballroom A3

8:45 AM – 10:00 AM

- **Onsite Wastewater Treatment Facilities Management System**

Richard Otis and Bradley Chopp, Ayres Associates (30 Minutes)

A consortium of ten counties in northern Minnesota, the Iron Range Resources and Rehabilitation Agency, the Natural Resources Research Institute at the University of Minnesota-Duluth, MPCA, MDH, USEPA, and Ayres Associates have developed a performance-based code for onsite wastewater treatment regulation. Administering a performance code requires system inventorying, permit tracking, design review, compliance reporting, data logging, re-issuance of operating permits, reports of enforcement actions, confirmation of practitioner certifications, and other record keeping tasks. To be successful, administrative tools are needed which will not increase the costs of administration, but will relieve counties of routine, time-consuming tasks and to ensure accuracy of records and timely responses. This presentation will describe a web-based performance management and inventorying system based on ArcView, MS Word, Excel, and Access software that includes site evaluation and design tools to expedite permitting.

- **Electric Transmission Line Siting and Routing: Using Geospatial Integration to Actively Engage and Track Public Participation**

Andrea Beck and Sam Pociask, American Transmission Company (30 Minutes)

The need for electric transmission system improvement is driven by several major factors, including a rapidly aging infrastructure, the inability of existing infrastructure to support expanding generation load output, and the lack of reliable network connectivity to the larger North American electric grid. ATC system planners identify required improvements and alternatives to address not only system operating capacity, but also the reliability and ability of the system to handle outages and growth over time. For projects requiring new transmission lines, ATC actively engages potentially impacted stakeholders before routing decisions are made. By integrating geospatial data with a relational database of stakeholder contacts, we now can provide highly relevant visual aide in support of project need prior to route selection, and stakeholder contacts are consistently managed in a spatial context.

Track 4: Parcels - Ballroom A4

8:45 AM – 10:00 AM

- **Integrating Parcels Into Farm Records Management**

Larry Cutforth, USDA (30 Minutes)

The objective of this presentation is to describe lessons learned from integrating parcels into the process of farm field boundary digitizing and on-going maintenance in 14 Wisconsin counties. In particular, the impact of parcel access policies, accuracy, and delineation standards will be discussed in relation to the development of another cadastral layer.

- **Attribute Centerlines from Parcels**

Eric Fowler, R.A. Smith & Associates (30 Minutes)

Make those parcels work for you! The parcel database has extensive street and address information. Using ArcGIS

Parcels Track continued on page 16...

- *Attribute Centerlines from Parcels continued...*

customization tools, the parcel information can attribute the centerline file for new segments or maintenance of existing segments. This presentation will discuss the process of customizing ArcMap to transfer parcel attributes (street names, addresses) to the street segment fronting the parcels. Several customized tools will be discussed and a code template for one of the tools will be given to the audience.

10:00 AM – 10:15 AM - Break with Exhibitors

10:15 AM – 11:30 AM - Technical Sessions

Track 1: Data Integration - Ballroom A1

10:15 AM – 11:30 AM

- **Snow Plow Routing and Optimization - Transportation Facility Studies**

Jon Schwichtenberg, SEH (30 Minutes)

This presentation will cover the use of GIS in Optimization of Snow Plow Routes and Facility Studies. The presentation will go through the process of optimization for snow plow routes and how it differs from traditional routing, along with presenting a case study for a county.

- **Data Integration Between County Offices**

Tim Lehmann, Buffalo County; Brian Sovik, ACS/GTG & Kevin Delany, Affiliated Computer Services; Dave Ritter, GCS Software (30 Minutes)

This presentation will show how Buffalo County is able to share data back and forth between various County departments utilizing software applications from ACS, GTG & GCS. Data being shared at the present time includes Register of Deeds documents, Tax Parcel Information, Highway road information generated from the Paser program, and various GIS data sets. Departments involved are Register of Deeds, Treasurer, Real Property Lister, Land Information, Health and Human Services, Emergency Management, Highway, and Zoning.

Track 2: Imagery & Terrain - Ballroom A2

10:15 AM – 11:30 AM

- **Historic Digital Orthophotography 101**

John Erickson and Jason Krueger, Continental Mapping Consultants (30 Minutes)

Discover some of the infinite uses of historic digital orthophotography and how easy it is to obtain the aerial photos that you may not even know exist! Continental Mapping Consultants, Inc. has developed an effective relationship with several of the federal and state archival organizations that may possess photography from the 1930's through the 1990's for your county or municipality. This session will cover how to conduct an investigation to find the existing photography that best suits your needs, production processes that range from 2-D registration to full rectification and their related accuracies, and an example county-wide, historic orthophotography project.

- **LIDAR - Not Just for Orthos's Anymore**

Larry Christianson, Woolpert Inc. (30 Minutes)

Woolpert was contracted to collect LiDAR data over a two-mile project site along Oakwood Road from Four Mile Road northerly to Six Mile Road. The project called for the production of 1"=40' scale mapping with full planimetric detail from 1"=300' scale aerial photography and LiDAR data acquired at 3,300 feet AGL (high) and at 1,500 feet AGL (low). This was done to facilitate the desire of WisDOT to thoroughly test the resultant LiDAR data sets. LiDAR has proven instrumental in producing a surface model capable of contour generation for engineering applications, such as design and construction. Additionally, the digital imagery can be used as a base map for route selection, feasibility studies and design. LiDAR can be used not only to rectify the photography for orthophoto production, but also used to generate contours for grading plans, cut and fill calculations, and infrastructure plan and profile sheets.

Track 3: Planning - Ballroom A3

10:15 AM – 11:30 AM

• **A Comprehensive Web Resource for Community Planning**

Jeff Sledge, UW-Madison - LICGF (30 Minutes)

The Community Planning Resource Web site (CPR) is a service of the Land Information and Computer Graphics Facility. We have assembled a broad selection of resources to help elected officials, planning professionals, advocates, landowners, and anyone else concerned about land use, understand the issues and access the tools needed to participate in decisions about Wisconsin's future. Planning for development and change is essential for developing healthy communities that meet the needs of the residents while remaining economically strong and environmentally friendly. The Community Planning Resources Web site contains information, guidelines and tools for people with varying levels of expertise in planning, from the concerned citizen to the trained professional. Our instructions for land use planning follow the guidelines set by the State of Wisconsin's Comprehensive Planning Law.

• **Thinking Long Term and Big Picture: Land Use Planning in Dane County**

Tom McClintock, UW Madison - LICGF (30 Minutes)

Typical land use planning seeks to envision what a community might be like in ten to twenty years, when another round of planning occurs. This approach is largely reactive to prevailing conditions and forces, rather than proactively setting an agenda for sustainable and orderly growth over the long term future. By looking at planning horizons of 50 or more years, Dane County has recognized that the planning luxury of "open and undeveloped" land will not last. Within a few decades, all land in the county will either be developed or in some cases protected from development through various programs such as public acquisition, transfer or purchase of development rights, or farmland protection programs. To make sure that the best or most appropriate lands are slotted into these categories, we have developed a series of suitability models for ecosystem services, farmland protection, landscape amenities, and housing suitability. The results of these models are then fed into impact analysis models such as WhatIf? And CommunityViz to determine optimal mixes of future land uses and to describe the potential impacts of various scenarios.

Track 4: Applications - Ballroom A4

10:15 AM – 11:30 AM

• **A New Look for Zoning and Planning Technology**

Larry Nies, NSC Inc., Software Solutions (30 Minutes)

A comprehensive look at the newest methods in Zoning and Planning permit management. See how you can access your data by using the latest in Internet technology. Provide tools for your staff to better organize all aspects of your county's zoning and planning records. Create permits and other legal documents specific to your county, and link your images related to this data. So don't forget to join us for an exciting look at a solution that can help you today and into the future.

• **Faster, Easier Parcel Mapping in ESRI ArcGIS 9.0**

Joe Hanousek, UCLID Software (30 Minutes)

Automated mapping has been proven to reduce the costs of GIS data entry. County GIS Managers report that they are able to make better use of staff resources, offer 24-hour turnaround of parcel edits and provide better support to other county agencies with IcoMap for ArcGIS. Some of the nation's fastest-growing counties use IcoMap because it allows them to work faster, completing more mapping in less time than before. In this informative presentation you'll see demonstrations of IcoMap's unique parcel mapping capabilities including scan conversion and speech recognition. Anyone looking to improve their mapping workflow is encouraged to attend.

11:30 AM – 11:45 AM Break

11:45 AM – 12:45 PM Technical Sessions on next page

Track 1: Data Integration - Ballroom A1

11:45 AM – 12:45 PM

• **Rapid Data Integration and Quality Assurance in a New Municipal Enterprise GIS**

Andy Swartz, City of Sun Prairie (25 Minutes)

This presentation will underscore the importance of streamlining and automating methods for integrating new data into a GIS. Also, protocol for data quality assurance at the City of Sun Prairie will be shared. As a rapidly growing municipality with an ambitious enterprise GIS development project underway, the City has taken innovative steps to quickly integrate new data into the GIS. Key steps included: development of a roadway naming and property addressing standard, development of GIS-friendly submittal requirements for subdivisions and engineering record drawings, and development of a master address database. The integration of utility infrastructure data into the Hansen City management software suite will be demonstrated. Also, workflow analyses have led to changes in data ownership, maintenance and distribution, and increased data quality. The result is an effective GIS with improved public safety support, greater staff efficiency, and increased potential for bona fide decision support in a rapidly growing municipality.

• **Integrating As-Built Policies and GIS Maintenance Procedures**

Sierk Oudemans, Ruekert/Mielke, Inc. (25 Minutes)

This session will discuss how government can integrate the collection of as-built information (record drawings) and the maintenance of the GIS utility data. Find out how to get developers to deliver useful digital as-built information and to provide options to facilitate compliance. Learn how to develop a specification for delivery of digital as-built data and for converting the delivered data into your GIS utility components.

Track 2: Imagery & Terrain - Ballroom A2

11:45 AM – 12:45 PM

• **Jefferson County LIDAR Terrain Mapping Project**

Andy Erdman, Jefferson County (25 Minutes)

This presentation will provide an overview of the 2004 LIDAR/Orthophotography project covering 288 square miles that make up the north half of Jefferson County. The project included contracting for survey control, LIDAR acquisition, Aerial photo acquisition, terrain modeling and planimetric mapping. The presenter will discuss project goals, planning and specifications. Utilization of the Wisconsin Height Modernization Control, methodologies for determining positional accuracy of deliverables and other quality control measures will be explained. Examples of the digital terrain model and other project deliverables will also be shown.

• **Address Mapping in Ozaukee County; A different route**

Damon Anderson, Ozaukee County (25 Minutes)

Ozaukee County was in need of a complete road centerline and address data set. The primary use is for wireline and wireless 911 services. However, the data set will be used for multiple other applications. Confronted with a choice between a traditional digitize over ortho product and an alternative image based method of capturing the roadways, Ozaukee County chose imaging the roadways. Methodology, costs, alternative uses, partnerships, pros and cons will be discussed.

Track 3: Planning - Ballroom A3

11:45 AM – 12:45 PM

The Yellow River Watershed Initiative– Using ArcIMS for Comprehensive Planning

Mitch Moline, GeoSpatial Services (25 Minutes)

The Yellow River Watershed Initiative is a partnership effort of Federal agencies, Iowa state agencies, local government offices, non-governmental organizations, and interested local citizens. Goals of the Yellow River Initiative are to (1) assess the natural resources within the Yellow River watershed (2) allow a team of federal and local non-federal partners to summarize the results and use them to identify options to promote long-term sustainability (3) develop a web-based “ToolBox” of technical assistance information and (4) enable people to voluntarily use this information to help them achieve natural resource sustainability and stewardship. Success of this project will enable similar initiatives to be launched for other comprehensive planning efforts

• **The MapTEACH Project: Place-Based Geospatial Science Learning & Applications in Rural Alaska**

Tim Olsen, Sam Batzli, Bil Aldrich, Scott Gebhard and Khary Jeffers, Environmental Remote Sensing (25 Minutes)

Traditions-based people in rural communities possess a deep and extensive knowledge of their landscape and its physical and human geography. Place-based learning differs from the orientation of most educational processes by beginning with people who share resources, problems and expertise at one place, and by requiring that technological tools and information adapt to serve their goals, and their ways of knowing. This presentation describes process and progress for our NSF-supported Information Technology Experiences for (Secondary) Students and Teachers (ITEST) project. Key dimensions include: 1) Native Elders committed to program participation; 2) local natural resource opportunities for economic development; 3) geologic and remotely sensed data; 4) mobile geospatial data gathering and documentation by students working and camping in sub arctic conditions; 5) capacity for web-serving spatial database information, and 6) capstone field research and reports. Together these enable students to experience authentic science roles within a local cultural context.

Track 4: Applications - Ballroom A4

11:45 AM – 12:45 PM

• **River Alliance Small Dam Removal Prioritization**

Mark Wegener, Patrick Engineering and Helen Sarakinos, River Alliance (30 Minutes)

The Lake Michigan Basin Small Dam Removal GIS project involved assembling a GIS database for the 630 dams in Wisconsin’s Lake Michigan Basin, and using spatial analysis tools to rank the dams based on the potential benefit of their removal. These rankings reflect the River Alliance of Wisconsin’s priorities for dam removal in the state, and are included at both basin and watershed scales. In addition, a custom GIS tool called the “DamID Tool” was created to support wide-spread viewing of the data along with all of the analysis results.

• **Visual Intelligence for Land Information**

Scott Sherwood, Pictometry (25 Minutes)

Pictometry is a unique and revolutionary new technology being used by Federal, State and Local governments across the United States for land, environmental, and public safety information systems. It has patented methods of capturing, processing, and analyzing a NEW form of aerial photography. Pictometry libraries consist of orthogonal (straight down) images like traditional aerial imaging. However, over 80% of Pictometry’s images are oblique (taken from angles) so that features can be easily seen in their entirety. Within 15 to 20 seconds, using a Pictometry image library and the Electronic Field Study (EFS) software, a user can literally view and analyze any house, building, intersection, fire hydrant, tree, or any feature in their county from their laptop or workstation. Features can be seen from at least three, and up to eight or nine, different views. The images are in full color, high resolution, digital format.

12:45 PM – 2:15 PM

Lunch / Awards / Prizes - Meeting Room B

2:15 PM – 3:00 PM

New WLIA Board Meeting



Map Gallery Competition / Poster Contest

TACKLE the competition with your best map!!!

Now is the time to prepare your entry for the WLIA 2005 Conference Map Gallery. Please complete the entry form (available at www.wlia.org) and bring it with you — along with your map and a digital copy of your map to the conference. Please drop off at the conference registration desk. Maps may be any size or shape, though suitable for “conference-style” viewing. Winners will be acknowledged at the Conference Awards Ceremony Luncheon on Thursday, February 24, 2005. Awards will be presented for all 8 application categories in addition to three others: *President’s Choice Award*, *People’s Choice Award* and *Best Student Award*.

For the Interactive Web-Based Mapping category, a computer will be available on-site for conference attendees to view the Web site. No paper or digital submissions are required for this category.

Entries will require a digital copy of the map be submitted at (or prior to) the conference in order to be eligible for award. Please provide digital submissions in Adobe Acrobat format, however, TIF, PNG, JPEG and GIF are also acceptable. The resolution of the output file should be between 80-133 DPI. Files should be less than 5 MB in size.

Judging will take place on Wednesday, February 23, 2005 from 5:30 pm -7:30 pm.

Future WLIA Regional Meetings and Annual Conferences

2005 Spring Regional Meeting

June 16 & 17, 2005

Hayward Inn & Suites, Hayward

2005 Fall Regional Meeting

October 20 & 21, 2005

WWTC, Radisson Hotel, La Crosse

2006 ANNUAL CONFERENCE

February 28, March 1 - 2, 2006

Kalahari Resort, Wisconsin Dells

2006 Spring Regional Meeting

June 6 & 7, 2006

Osthoff Resort, Elkhart Lake

2006 Fall Regional Meeting

October 19 & 20, 2006

Stone Harbor Resort, Sturgeon Bay

2005 WLIA Annual Conference Details

***** Conference Sponsors*****

Ayres Associates is the 2005 Conference GOLD Sponsor!

Woolpert, LLC will sponsor the 2005 WLIA Lanyards!

SEH will sponsor HALF of the Wednesday Opening Luncheon!

ESRI will sponsor the Conference CD!

Pro-West & Associates, Inc. will sponsor part of a Soda Break!

Patrick Engineering will sponsor part of a Continental Breakfast!

UW-Madison LICGF will sponsor part of the Grand Opening Reception!

Thank you to our conference sponsors. They help make it possible to provide a quality program.

• 2005 Conference Committee

Chairperson: Ken Pabich, WLIA President-Elect

Alissa Bails	Tim Barnett
Chris Vanderheyden	Diann Danielsen
Jodi Helgeson	Cristina Pearson
Fred Halfen	Jeff Bluske
Mark Walter	Scott Galetka
Jeff DuMez	Paula Cummings
Marge Geissler	Jon Schwichtenberg
Jay Shambeau	Kyle Balke
Joyce Fiacco	Al Lulloff
Melissa Kraemer	Jerry Sullivan
Andy Hess	Brian Braithwaite
Brett Budrow	Mark Teuteberg
Bret Davies	James Lacy
Brad Bastian	Ann Barrett

• **Conference CD:** We again are producing a WLIA Conference CD for 2005. It will include digital presentations from the conference, digital versions of poster contest submissions, and more. WLIA publishes a membership directory and membership list on a conference CD. These are distributed only to WLIA members and member organizations.

• WLIA 2004 - 2005 Officers & Board of Directors

Officers:

Alissa Bails, President: R.A. Smith & Associates, Inc.

Ken Pabich, President-Elect: Calumet County

Jeff Bluske, Past President: La Crosse County

Directors:

Brian Braithwaite; Washington County

Brett Budrow; St. Croix County

Bret Davies; Juneau County

Jeffrey DuMez; Brown County

Joyce Fiacco; Dodge County

Scott Galetka; Lincoln County

Frederick Halfen; Ayres Associates

Jodi Helgeson; Adams County

Alan Lulloff; Association of State Floodplain Managers

Cristina Pearson; Iowa County

Jon Schwichtenberg; SEH, Inc.

Jay Shambeau; Clark County

Chris Vanderheyden; Double Digit Sales Growth, LLC

• General Information

Meals: The conference fee includes breaks and lunches on Wednesday and Thursday, and the reception on Wednesday evening.

Dress Code: Business casual is appropriate for the entire conference.

Registration/Badges: Be sure to register when you arrive at the conference. You will need a name badge to attend all conference functions. A final program will be distributed at the conference.

Job Board: We will have a bulletin board available near registration for you to post your job openings or resumes.

NOTE:

• **This year you have the option to join before the conference or at the same time you register for the conference.**

Membership runs on a calendar year; January through December.

• Membership Categories

Individual: Available to anyone with an interest in advancing the association's mission.

Organization: For any for-profit or non-profit organization or institution of higher education with an interest in advancing the association's mission. One person will receive all mailings. The organization will receive a mailing list of members, be able to exhibit, advertise in the WLIA newsletter and have a company description in the membership directory and on the website. This is not a group rate.

Student: Available to any individual enrolled in a post-secondary educational institution.

2005 Annual Conference Exhibitors

ACS Government Systems
 Aero-Metric, Inc.
 Applied Data Consultants, Inc.
 AtPac
Ayres Associates – 2005 WLIA GOLD SPONSOR!
 CDW Government
 Continental Mapping Consultants, Inc.
 Cott Systems, Inc.
ESRI Minneapolis – SPONSOR!
 General Code
 GeoComm, Inc.
 Geospatial Services, Inc.
 Horizons, Inc.
 HRG Technology Group
 ImageAmerica
 ImageTek, Inc.
 Kapur & Associates, Inc.
 Kucera International, Inc.
 Mastergraphics
 Meridian Mapping

MSA Professional Services
 Nazca Solutions, Inc.
 NSC, Inc.
Patrick Engineering, Inc. – SPONSOR!
 Pictometry International Corporation
Pro-West & Associates – SPONSOR!
 R.A. Smith & Associates, Inc.
 Ruekert/Mielke, Inc.
SEH, Inc. – SPONSOR!
 Taylor Technologies, Inc.
 Uclid Software, LLC
 US Geological Survey
 USDA Farm Service Agency
UW Madison LICGF – SPONSOR!
 UW Madison State Cartographer's Office
 WI Geological & Natural History Survey
 WI Register of Deeds Association
 WI Society of Land Surveyors
Woolpert, Inc. – SPONSOR!
 WI Real Property Listers Association

KI Convention Center and Regency Suites Floor Plan

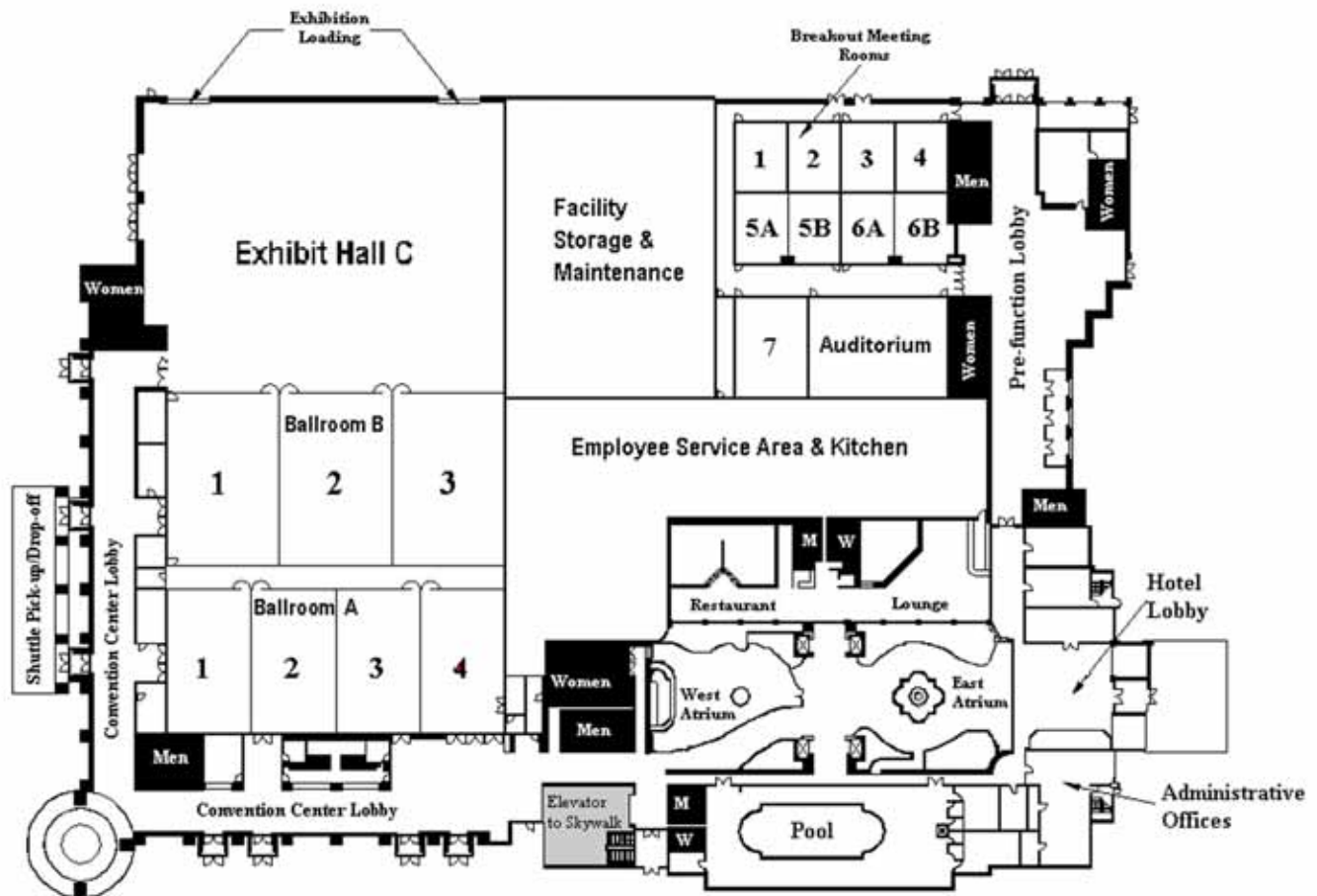



W I S C O N S I N
L A N D I N F O R M A T I O N
A S S O C I A T I O N

Application

- Individual \$50
 Organization \$200
 Student \$25
 Amount enclosed \$ _____

NAME _____

TITLE/POSITION _____

ORGANIZATION _____

PO BOX/STREET ADDRESS _____

CITY _____ COUNTY _____

STATE _____ ZIP _____

PHONE _____ FAX _____

EMAIL _____

Make check or money order payable to WLIA and mail to:

Wisconsin Land Information Association
 P.O. Box 389, Wild Rose, WI 54984
 Phone 800-344-0421 • Fax 715-366-4501
 abarrett@uniontel.net
 www.wlia.org

Also payable by Visa or Mastercard.

NAME ON CARD _____

CARD NUMBER _____ EXP. DATE _____

SIGNATURE _____

Membership

INDIVIDUAL MEMBERSHIP

- Available to anyone with an interest in advancing the association's mission.

ORGANIZATION MEMBERSHIP

- Available to any for-profit business, not-for-profit professional or trade organization, or agency of local, state or federal government, or institution of higher education interested in marketing to other WLIA members.
- Each organization will be provided an individual membership to a person designated by the member organization.

Each organization member will:

- Annually receive a mailing list of WLIA members.
- Be encouraged to exhibit at the association's annual conference.
- Be able to advertise in association's newsletter.

STUDENT MEMBERSHIP

- Available to any individual enrolled in a post-secondary educational institution interested in advancing the mission of the association.
- Each student member will be permitted to participate in the activities of the association, but will not have voting privileges.



W I S C O N S I N
L A N D I N F O R M A T I O N
A S S O C I A T I O N

Wisconsin Land Information Association 2005 Eighteenth Annual Conference *“Tackling Data Integration”*

February 22 - 24, 2005
Regency Suites / KI Convention Center
Green Bay, Wisconsin

A special thank you to Ayres Associates for being our major sponsor!

Ayres Associates: 2005 Conference Gold Sponsor!

2005 Wisconsin Regional Mapping Initiative

Ayres Associates – along with 3 regional planning commissions, 34 counties and 150 other partners – are mapping **1/2 of Wisconsin**.

There’s still time for you to join the partnership!

Through partnerships, we can help you meet the challenges you face – and produce results. We've built our reputation on providing quality services:

- Aerial photography
- Airborne GPS
- Digital orthophotography
- Remote sensing
- Survey
- GIS
- LiDAR
- Planimetric and topographic mapping



AYRES ASSOCIATES Engineers
Photogrammetrists
Scientists
Surveyors

www.AyresAssociates.com

A proud sponsor of WLIA.

WLIA
Conference 2005